

Brake Shoes

Inspection

1. Inspect the wheel cylinders for leakage.
2. Inspect the brake linings for cracking, glazing, wear or contamination.
3. Measure the brake lining thickness.

Lining Thickness

(Does not include brake shoe thickness)

Standard: 4.5 mm (0.177 in.)

Service Limit: 2.0 mm (0.079 in.)

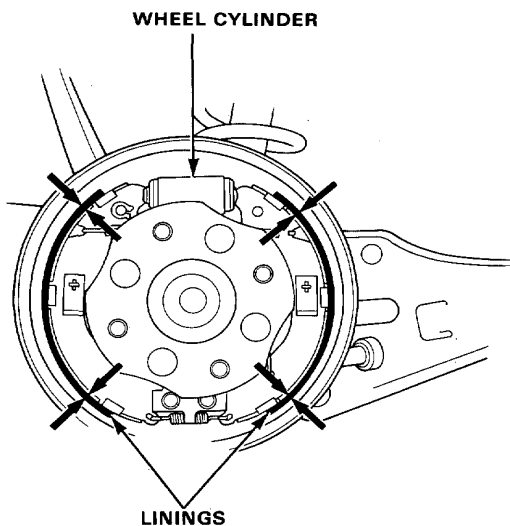

4. Inspect bearings in hub unit for smooth operation. If defective, refer to Section 12.
5. Measure inside diameter of the brake drum.

Drum Inside Diameter:

Standard: 220 mm (8.661 in.)

Service Limit: 221 mm (8.701 in.)

NOTE: If the refinishing limit stamped on the drum does not match the one listed above, use the one on the drum.

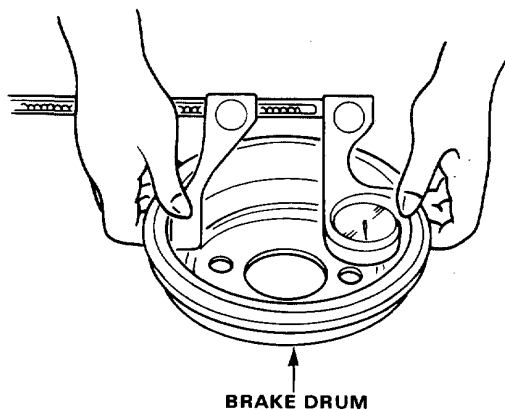

6. Inspect the brake drum for scoring, grooving, cracks.



Disassembly

1. Remove the upper return spring from the brake shoe as shown.

▲WARNING

Wear eye protection when using the brake spring tool.

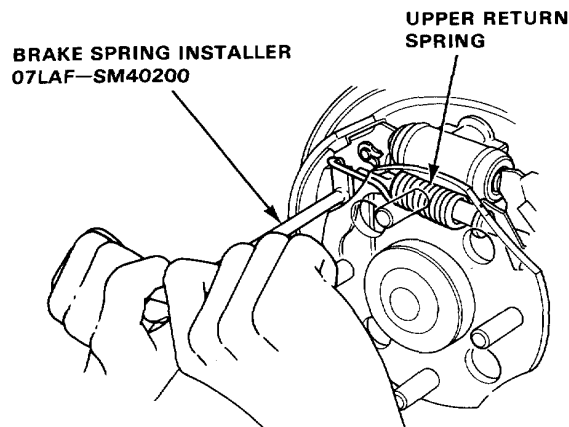

2. Remove the tension pins by pushing the retainer spring and turning them.
3. Lower the brake shoe assembly and remove the lower return spring.

NOTE: Make sure not to damage the dust cover on the wheel cylinder.

4. Remove the brake shoe assembly.

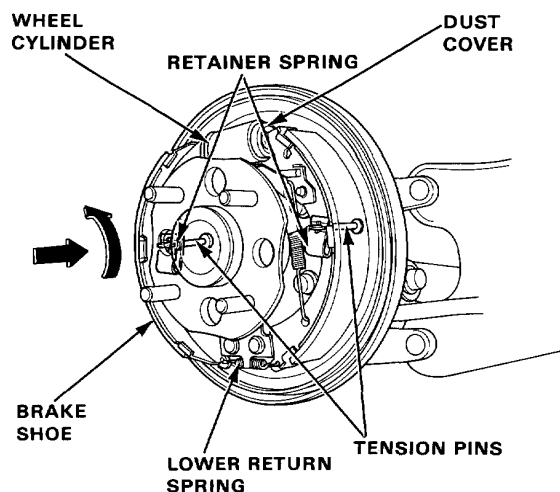

5. Disconnect the parking brake cable from the parking brake lever.

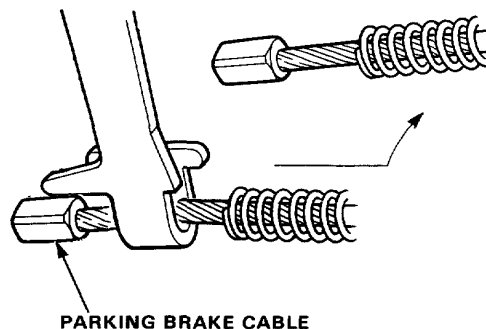

6. Remove the upper return spring, self-adjuster lever and self-adjuster spring, and separate the brake shoes.

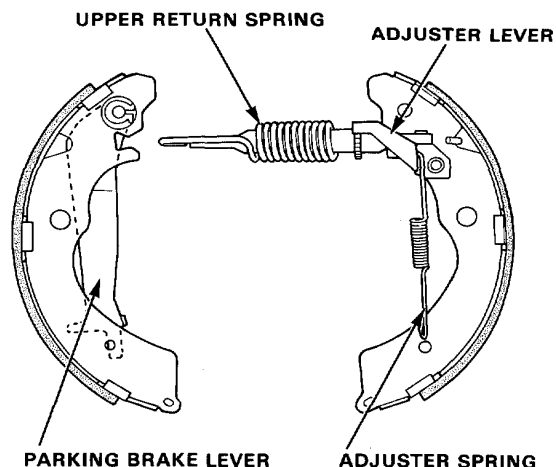

7. Remove the wave washer, parking brake lever and pivot pin from the brake shoe by removing the U-clip.

